

OERB AD 2.1 AERODROME LOCATION INDICATOR AND NAME**OERB - RABIGH / Rabigh (Domestic)****OERB AD 2.2 AERODROME GEOGRAPHICAL AND ADMINISTRATIVE DATA**

1	ARP coordinates and site at AD	224209N 0390412E
2	Direction and distance from (city)	10 KM south of the city
3	Elevation/Reference temperature	22 FT/39°C
4	Geoid undulation at AD ELEV PSN	19 FT
5	MAG VAR/Annual change	4°E (2010)
6	AD Administration, address, telephone, telefax, telex, AFS	General Authority Of Civil Aviation Rabigh Airport Rabigh Saudi Arabia
7	Types of traffic permitted (IFR/VFR)	VFR
8	Remarks	PPR except Saudia Airlines Flight Training Academy

OERB AD 2.3 OPERATIONAL HOURS

1	AD Administration	HS SUN - THU : 05:00 - 13:00 (0800-1600 LMT)
2	Customs and immigration	NIL
3	Health and sanitation	NIL
4	AIS Briefing Office	NIL
5	ATS Reporting Office (ARO)	NIL
6	MET Briefing Office	NIL
7	ATS	NIL
8	Fuelling	05:00 - 13:00
9	Handling	NIL
10	Security	H24
11	De-icing	NIL
12	Remarks	Operational hours from SUN to THU 05:00-13:00 UTC

OERB AD 2.4 HANDLING SERVICES AND FACILITIES

1	Cargo-handling facilities	NIL
2	Fuel/oil types	100LL AVGAS / (Aero Shell100) and (Aero Shell w15w-50)
3	Fuelling facilities/capacity	20000 gallons
4	De-icing facilities	NIL
5	Hangar space for visiting aircraft	NIL
6	Repair facilities for visiting aircraft	NIL
7	Remarks	NIL

OERB AD 2.5 PASSENGER FACILITIES

1	Hotels	NIL
2	Restaurants	NIL
3	Transportation	NIL
4	Medical facilities	NIL
5	Bank and Post Office	NIL
6	Tourist Office	NIL
7	Remarks	NIL

OERB AD 2.6 RESCUE AND FIRE FIGHTING SERVICES

1	AD category for fire fighting	CAT 2
2	Rescue equipment	2 fire truck + water tanker + ambulance
3	Capability for removal of disabled aircraft	NIL
4	Remarks	NIL

OERB AD 2.7 SEASONAL AVAILABILITY - CLEARING

1	Types of clearing equipment	NIL
2	Clearance priorities	NIL
3	Remarks	NIL

OERB AD 2.8 APRONS, TAXIWAYS AND CHECK LOCATIONS/POSITIONS DATA

1	Apron surface and strength	Surface: Asphalt Strength: 35 / F / A / X / T
2	Taxiway width, surface and strength	Width: 20 M Surface: Asphalt Strength: 35 / F / A / X / T
3	Altimeter checkpoint location and elevation	NIL
4	VOR checkpoints	NIL
5	INS checkpoints	NIL
6	Remarks	NIL

OERB AD 2.9 SURFACE MOVEMENT GUIDANCE AND CONTROL SYSTEM AND MARKINGS

1	Use of aircraft stand ID signs, TWY guide lines and visual docking/parking guidance system of aircraft stands	NIL
2	RWY and TWY markings and LGT	RWY marking: CL, Edge, ID, TDZ, THR, pre threshold TWY marking: CL, Edge, Holding Position for center TWY only
3	Stop bars	Apron Navigational Marking
4	Remarks	NIL

OERB AD 2.10 AERODROME OBSTACLES

In approach/TKOF areas			In circling area and at AD		Remarks
1			2		3
RWY NR/Area affected	Obstacle type Elevation Markings/LGT	Coordinates	Obstacle type Elevation Markings/LGT	Coordinates	
a	b	c	a	b	
NIL	NIL	NIL	NIL	NIL	NIL

OERB AD 2.11 METEOROLOGICAL INFORMATION PROVIDED

1	Associated MET Office	NIL
2	Hours of service MET Office outside hours	NIL
3	Office responsible for TAF preparation Periods of validity	NIL
4	Trend forecast Interval of issuance	NIL
5	Briefing/consultation provided	NIL
6	Flight documentation Language(s) used	NIL
7	Charts and other information available for briefing or consultation	NIL
8	Supplementary equipment available for providing information	NIL
9	ATS units provided with information	NIL
10	Additional information (limitation of service, etc.)	NIL

OERB AD 2.12 RUNWAY PHYSICAL CHARACTERISTICS

Designations RWY NR	TRUE & MAG BRG	Dimensions of RWY(M)	Strength (PCN) and surface of RWY and SWY	THR coordinates RWY end coordinates THR geoid undulation	THR elevation and highest elevation of TDZ of precision APP RWY
1	2	3	4	5	6
15	153° GEO 149° MAG	2370 x 32	36/F/A/X/T Asphalt	224243.79N 0390352.61E GUND 19 FT	THR: 24 FT
33	333° GEO 329° MAG	2370 x 32	36/F/A/X/T Asphalt	224134.89N 0390430.82E GUND 18.6 FT	THR: 23.8 FT TDZ: 23.8 FT

Slope of RWY-SWY	SWY dimensions (M)	CWY dimensions (M)	Strip dimensions (M)	OFZ	Remarks
7	8	9	10	11	12
NIL	60 x 32	240 x 32	NIL	NIL	NIL
NIL	60 x 32	240 x 32	NIL	NIL	NIL

OERB AD 2.13 DECLARED DISTANCES

RWY Designator	TORA (M)	TODA (M)	ASDA (M)	LDA (M)	Remarks
1	2	3	4	5	6
15	2370	2610	2430	2370	NIL
33	2370	2610	2430	2370	NIL

OERB AD 2.14 APPROACH AND RUNWAY LIGHTING

RWY Designator	APCH LGT type LEN INTST	THR LGT colour WBAR	VASIS (MEHT) PAPI	TDZ, LGT LEN	RWY Centre Line LGT Length, spacing, colour, INTST	RWY edge LGT LEN, spacing, colour INTST	RWY End LGT colour WBAR	SWY LGT LEN (M) colour	Remarks
1	2	3	4	5	6	7	8	9	10
15	NIL	NIL	VASIS 3 bar	NIL	NIL	NIL	NIL	NIL	NIL
33	NIL	NIL	VASIS 3 bar	NIL	NIL	NIL	NIL	NIL	NIL

OERB AD 2.15 OTHER LIGHTING, SECONDARY POWER SUPPLY

1	ABN/IBN location, characteristics and operational hours	NIL
2	LDI location and LGT Anemometer location and LGT	NIL
3	TWY edge and centre line lighting	NIL
4	Secondary power supply/switch-over time	NIL
5	Remarks	NIL

OERB AD 2.16 HELICOPTER LANDING AREA

1	Coordinates TLOF or THR of FATO Geoid undulation	NIL
2	TLOF and/or FATO elevation M/FT	NIL
3	TLOF and FATO area dimensions, surface, strength, marking	NIL
4	True BRG of FATO	NIL
5	Declared distance available	NIL
6	APP and FATO lighting	NIL
7	Remarks	NIL

OERB AD 2.17 ATS AIRSPACE

1	Designation and lateral limits	ATZ: Circle radius of 5 NM centered on 224209N 0390412E
2	Vertical limits	SFC to 2500 FT AMSL
3	Airspace classification	Class G
4	ATS unit call sign Language(s)	NIL
5	Transition altitude	13000 FT

6	Remarks	TIBA: 122.800 MHZ 1- Avoid OER13 adjacent west of aerodrome SFC to 3 000 FT. 2- Civil light aircraft training OED03 day light hours . Non-participating aircraft should avoid OED03 (except arriving or departing Rabigh).
---	---------	--

OERB AD 2.18 ATS COMMUNICATION FACILITIES

Service designation	Call sign	Frequency	Hours of operation	Remarks
1	2	3	4	5
NIL	NIL	NIL	NIL	NIL

OERB AD 2.19 RADIO NAVIGATION AND LANDING AIDS

Type of aid, MAG VAR, CAT of ILS/MLS (For VOR/ILS/MLS, give declination)	ID	Frequency	Hours of operation	Position of transmitting antenna coordinates	Elevation of DME transmitting antenna	Remarks
1	2	3	4	5	6	7
VOR/DME	RBG	116.800 MHZ CH 115X	H24	224730.8N 0390549.8E	100 FT	GACA
LOC RWY 33	IRBG	108.100 MHZ	H24	224252.6N 0390347.7E		
GP		334.700 MHZ	H24	224145.3N 0390429.8E		
DME	IRBG		H24	224145.3N 0390429.8E	100 FT	

OERB AD 2.20 LOCAL TRAFFIC REGULATIONS

NIL

OERB AD 2.21 NOISE ABATEMENT PROCEDURES

NIL

OERB AD 2.22 FLIGHT PROCEDURES

NIL

OERB AD 2.23 ADDITIONAL INFORMATION

NIL

OERB AD 2.24 CHARTS RELATED TO AN AERODROME

Chart name

Page

Aerodrome chart

AD 2-OERB-7

INTENTIONALLY BLANK

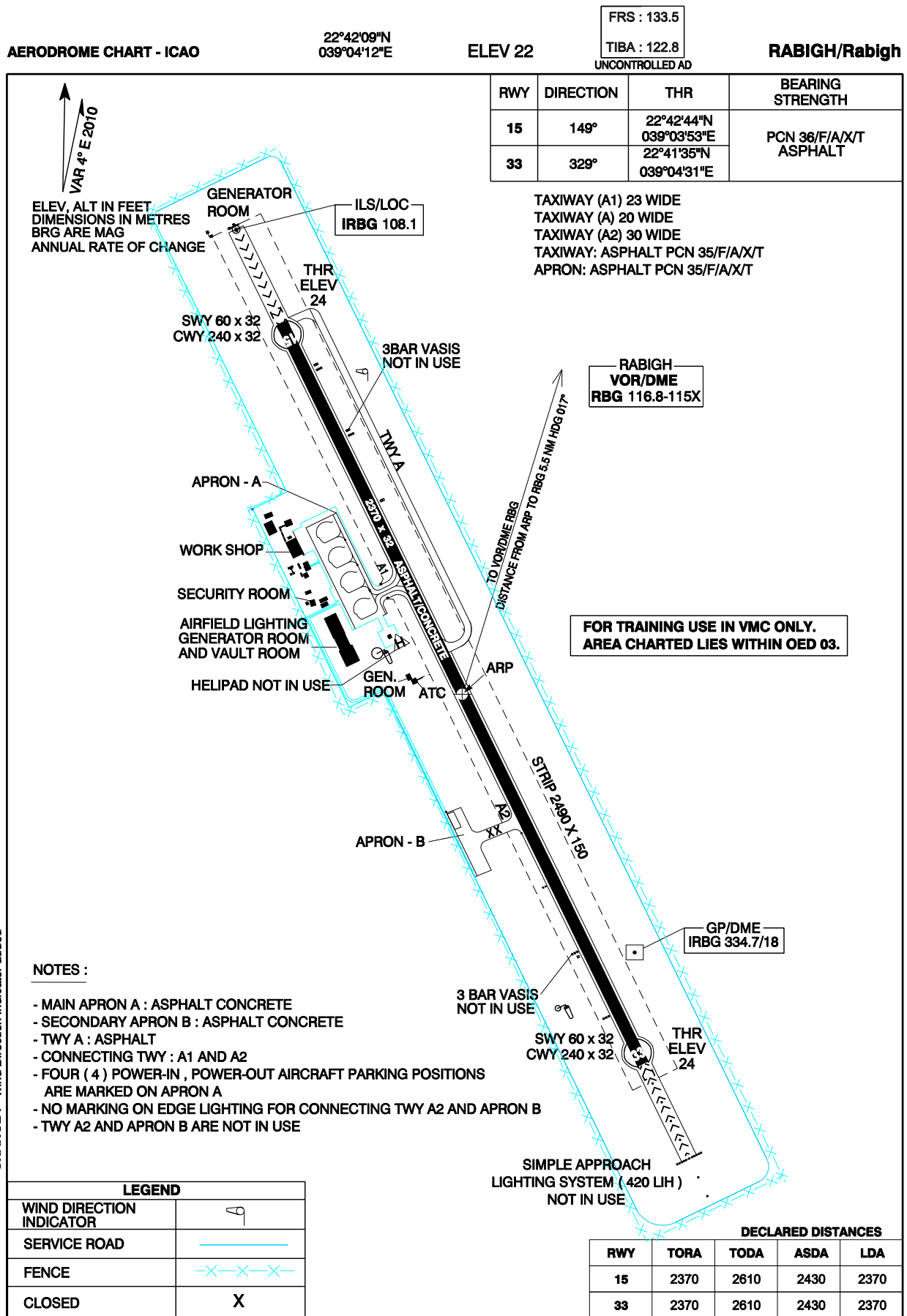

INTENTIONALLY BLANK